

Remote diagnosis between diagnostic equipment and diagnostic equipment

1. Click "Profile" > "My Friends"

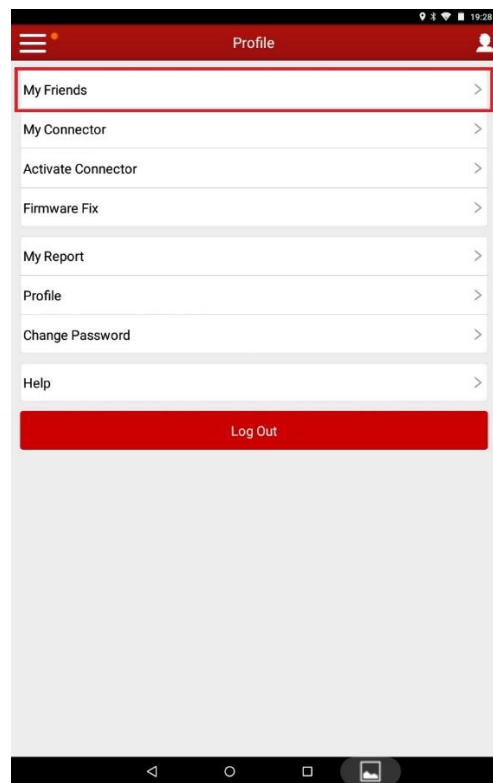

2. Click "Search", enter the username of other Pro/Pro3

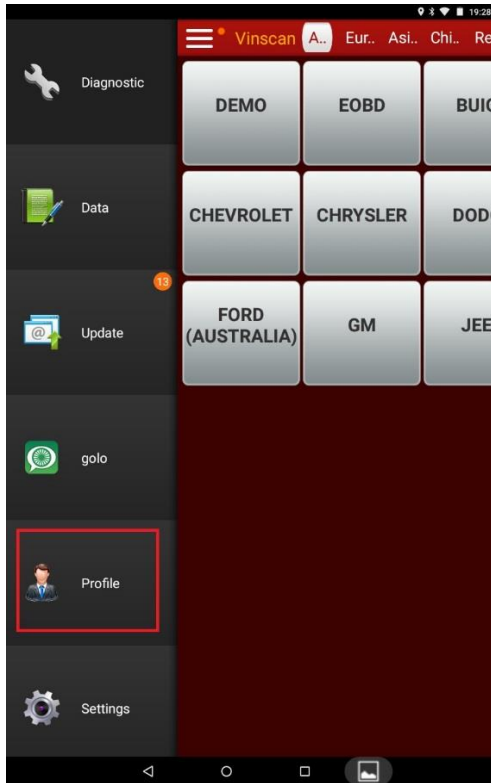
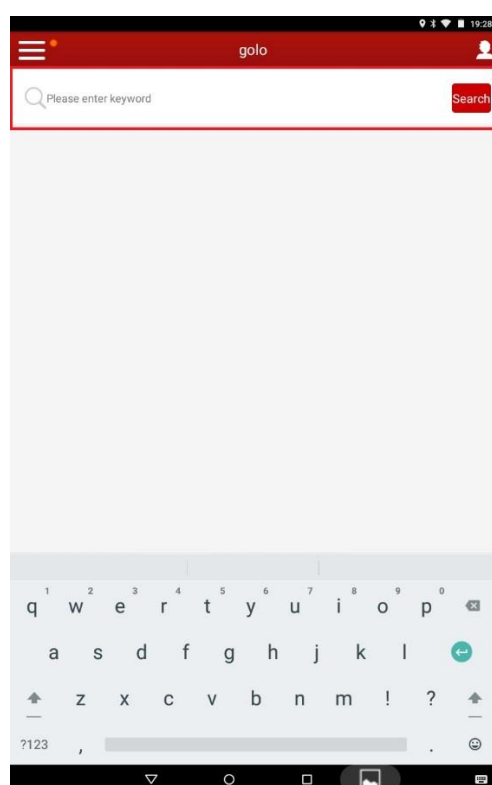
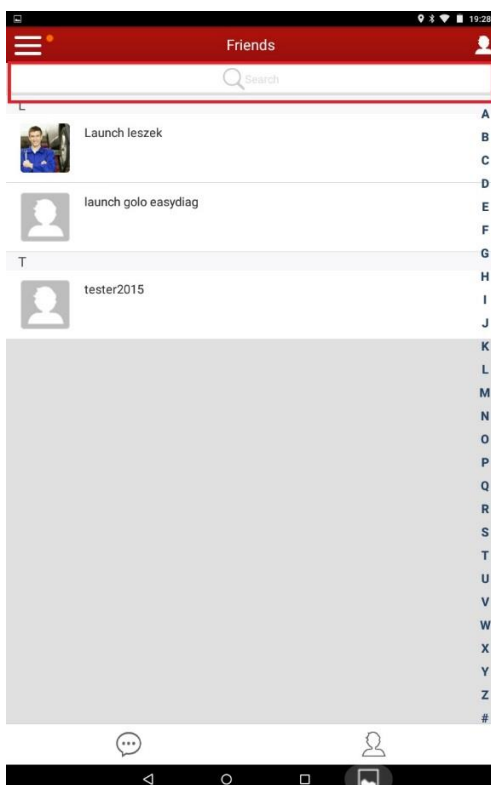

3. Click "Add"

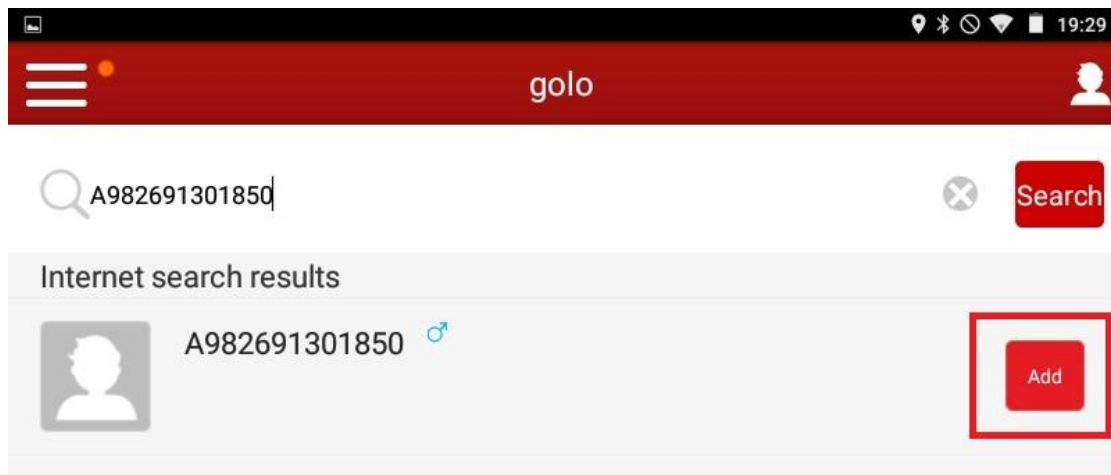

4. Enter the verification information and click "CONFIRM"

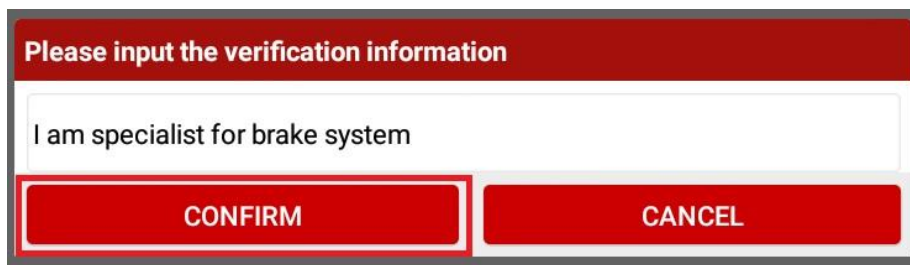

5. Wait for the acceptance of other side, after he has agreed, you will get the information and he will appear in your friends list

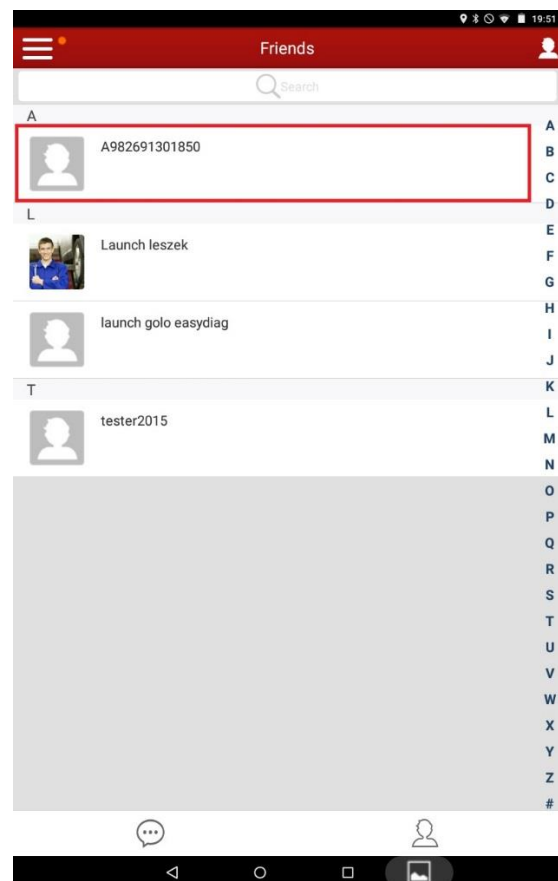
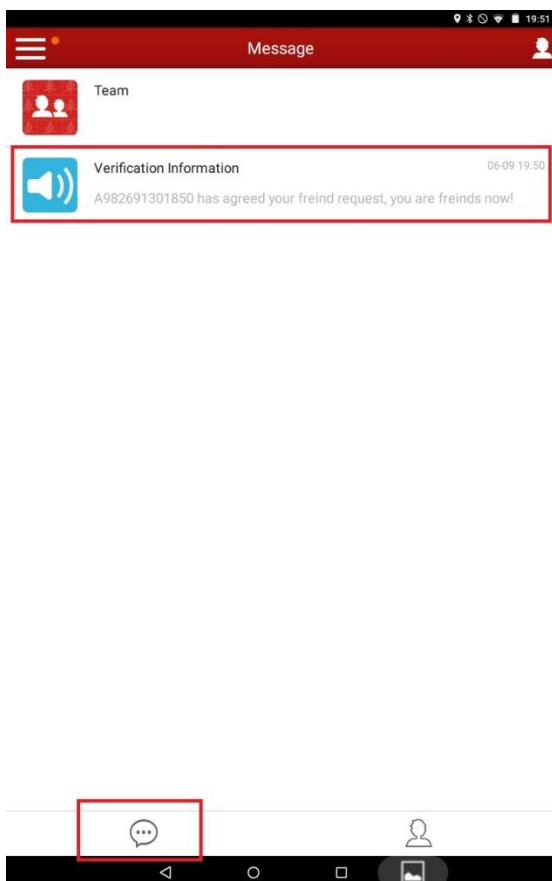

6. Choose a technician, click “PLUS” Symbol in the bottom of screen.

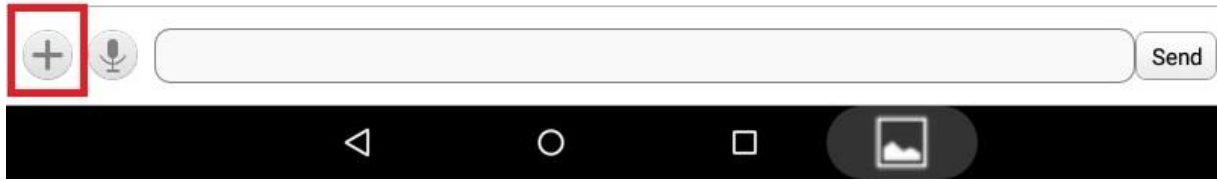

7. Click “Remote Diagnostic”, you can see the remote functions.

“Send remote diagnostic reservation”: send a reservation to determine the time

“Request control remote device”: you can see his screen and operate his Pro/Pro3

“Invite remote diagnostic assistant”: Let him to see your screen and operate your Pro/Pro3

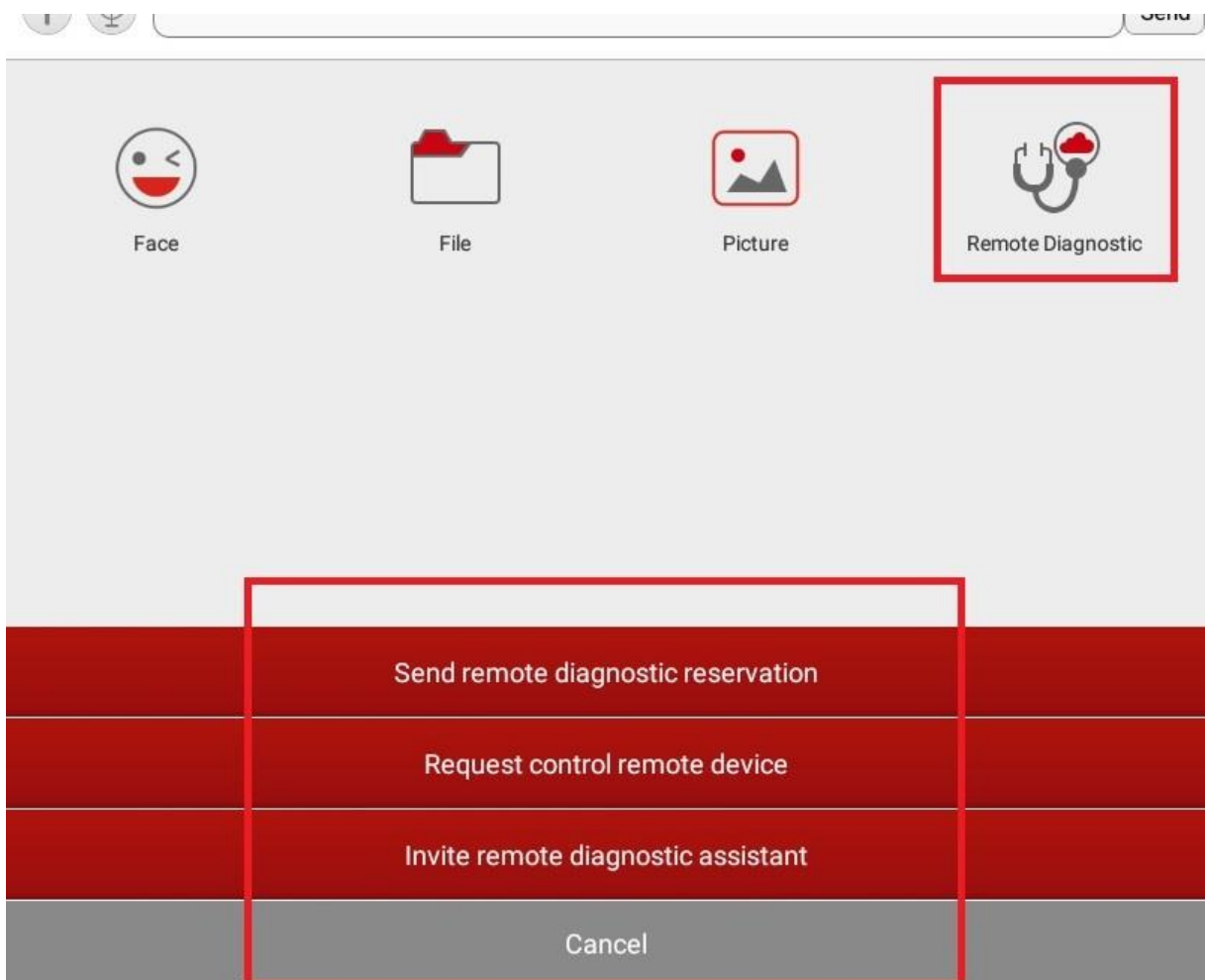

8. After he agrees your request, the remote diagnosis will start.